

**GENERAL NOTES**

- DO NOT SCALE DRAWINGS USE DIMENSIONS AS CALLED FOR ON DRAWINGS
- ALL DIMENSIONS ARE TO FACE OF STUD FACE OF FOUNDATION AND CENTERLINE OF LOG WALL, BEAM OR COLUMN
- IT IS THE RESPONSIBILITY OF THE BUILDER TO MONITOR THE SETTLING OF THE LOGS AND ADJUST THE SETTLING SCREWS WHEN NEEDED
- ALL INTERIOR WALLS ARE TO BE 2X4 @ 16" O.C. UNLESS NOTED OTHERWISE
- INSTALL 1/2" CEMENTITIOUS BACKERBOARD AT ALL SHOWER WALLS AND CEILINGS
- ALL SKEWED WALLS ARE 45° UNLESS NOTED OTHERWISE

**FLOOR PLAN FLAG NOTES**

- FLUE UP
- +36" COUNTER TOP
- HALF WALL +36" A.F.F
- SLOPE SLAB @ 1/8" PER FOOT (MIN)
- GAS FIREPLACE
- VAULTED CEILING
- BUILT IN FIXED SHELVES
- COOK TOP
- OVEN
- CONCRETE STEPS AS REQUIRED
- HANDRAIL
- GUARDRAIL
- STONE HEARTH
- DIRECT VENT
- WALL CLOSET SYSTEMS

CONCERNING A REQUIREMENT THAT CARBON MONOXIDE ALARMS BE INSTALLED IN RESIDENTIAL PROPERTIES  
*Be it enacted by the General Assembly of the State of Colorado*

\* 38-45-102 Carbon monoxide alarms in single-family dwellings \* Reg'd by Law  
 - rules (1) (a) NOTWITHSTANDING ANY OTHER PROVISION OF LAW, THE SELLER OF EACH EXISTING SINGLE-FAMILY DWELLING OFFERED FOR SALE OR TRANSFER ON OR AFTER JULY 1, 2009, THAT HAS A FUEL-FIRED HEATER OR APPLIANCE, A FIREPLACE, OR AN ATTACHED GARAGE SHALL ASSURE THAT AN OPERATIONAL CARBON MONOXIDE ALARM IS INSTALLED WITHIN FIFTEEN FEET OF THE ENTRANCE TO EACH ROOM LAWFULLY USED FOR SLEEPING PURPOSES OR IN A LOCATION AS SPECIFIED IN ANY BUILDING CODE ADOPTED BY THE STATE OR ANY LOCAL GOVERNMENT ENTITY

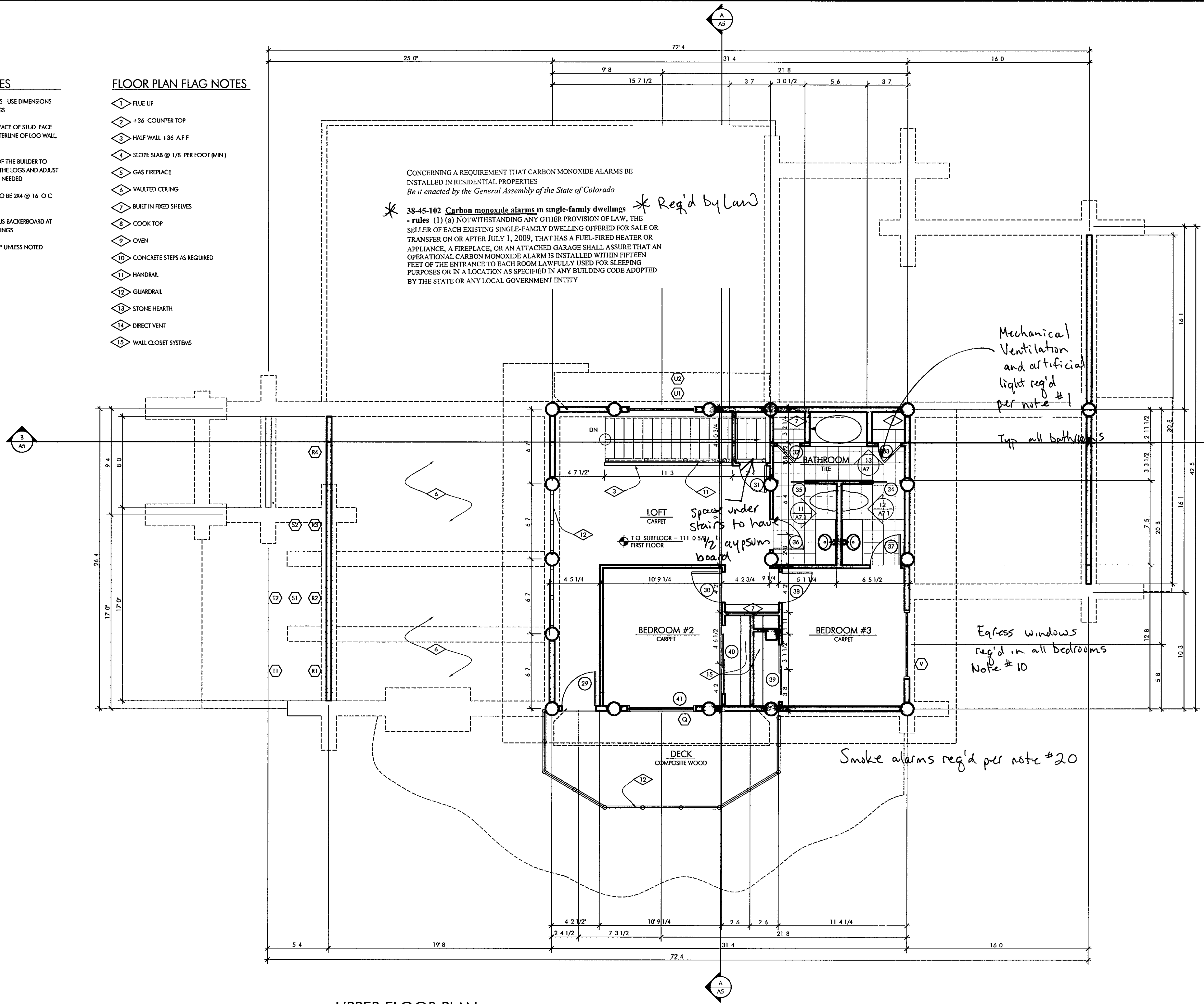

Mechanical Ventilation and artificial light reg'd per note #1

Typ all bathrooms

Space under stairs to have 1/2" gypsum board

Egress windows reg'd in all bedrooms Note #10

Smoke alarms reg'd per note #20

**UPPER FLOOR PLAN**  
 1/4" = 1'-0"

825 SQUARE FEET

**RAW architecture**  
 P 303.881.4597  
 F 303.881.1222  
 www.raw-architecture.com

© 2010 Raw Architecture, LLC. The use of these documents and drawings shall be restricted to the original project for which they were prepared. Any publication of these documents and specifications for any other project without the written consent of Raw Architecture, LLC shall be deemed a violation of the Title and contents of these drawings remain the property of Raw Architecture, LLC.

**JAMES RESIDENCE**  
 A custom home design  
 LOT 47 WOODEN CANOE AT WATER DANCE  
 Frisco Colorado

PROJECT # 09010

**10-097**

| DATE     | ISSUED FOR                        |
|----------|-----------------------------------|
| 03 19 10 | CONCEPT                           |
| 05 18 10 | DESIGN DEVELOPMENT                |
| 07 23 10 | DBS SUBMITTAL                     |
| 08 02 10 | SKETCH PLAN/ FINAL PLAN SUBMITTAL |
| 08 16 10 | FOR CONSTRUCTION                  |

SHEET

**A2.2**

STATE OF COLORADO  
 ARCHITECT  
 LICENSE # 6174