

**FLOOR PLAN FLAG NOTES**

- ◇ FLUE UP
- ◇ +36" COUNTER TOP
- ◇ HALF WALL +36" A.F.F.
- ◇ SLOPE SLAB @ 1/8" PER FOOT (MIN)
- ◇ GAS FIREPLACE
- ◇ VAULTED CEILING
- ◇ BUILT IN FIXED SHELVES
- ◇ COOK TOP
- ◇ OVEN
- ◇ CONCRETE STEPS AS REQUIRED
- ◇ HANDRAIL
- ◇ GUARDRAIL
- ◇ STONE HEARTH
- ◇ DIRECT VENT
- ◇ WALL CLOSET SYSTEMS

**GENERAL NOTES**

1. DO NOT SCALE DRAWINGS. USE DIMENSIONS AS CALLED FOR ON DRAWINGS.
2. ALL DIMENSIONS ARE TO FACE OF STUD FACE OF FOUNDATION AND CENTERLINE OF LOG WALL, BEAM OR COLUMN.
3. IT IS THE RESPONSIBILITY OF THE BUILDER TO MONITOR THE SETTLING OF THE LOGS AND ADJUST THE SETTLING SCREWS WHEN NEEDED.
4. ALL INTERIOR WALLS ARE TO BE 2X4 @ 16" O.C. UNLESS NOTED OTHERWISE.
5. INSTALL 1/2" CEMENTITIOUS BACKERBOARD AT ALL SHOWER WALLS AND CEILINGS.
6. ALL SKEWED WALLS ARE 45° UNLESS NOTED OTHERWISE.

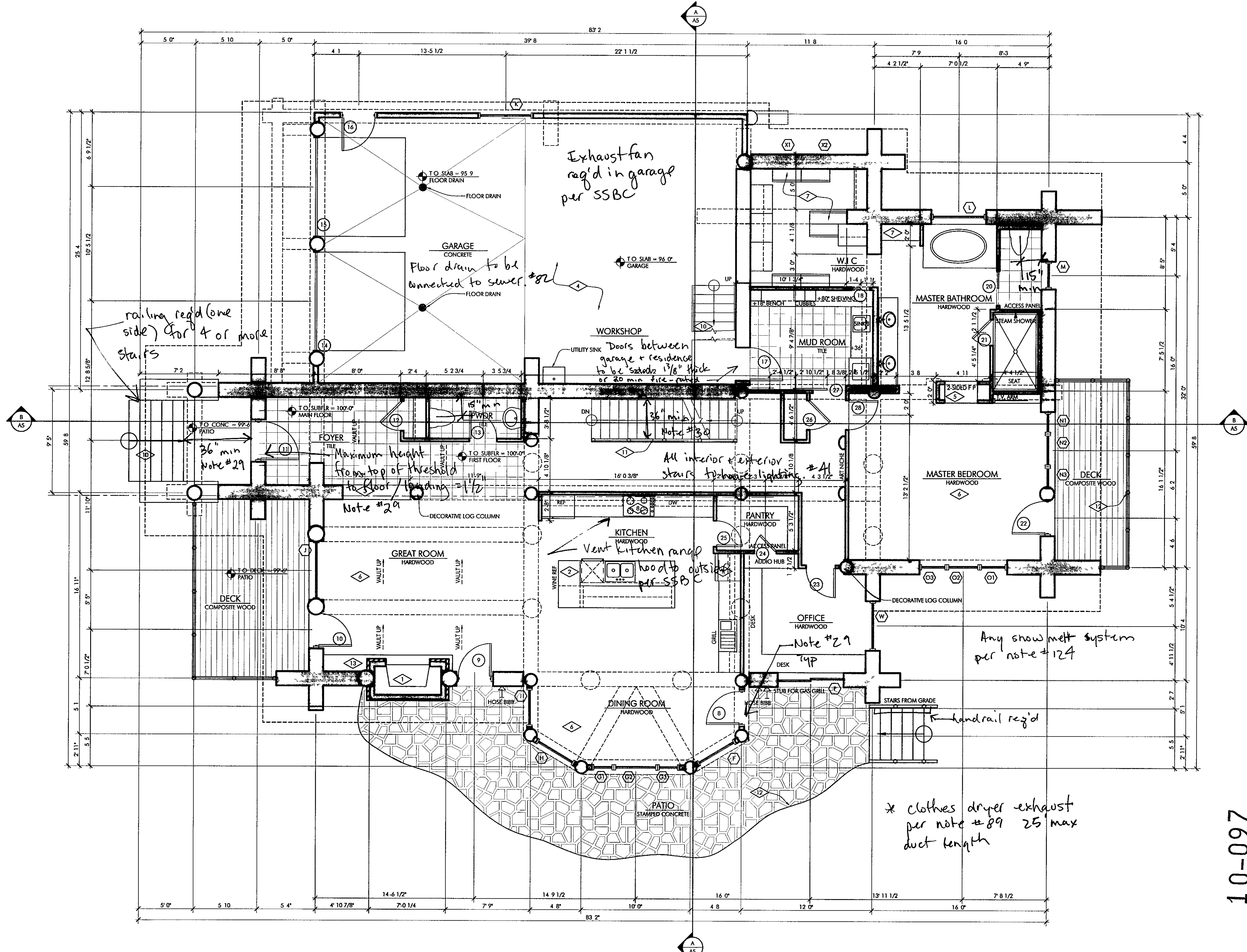

**MAIN FLOOR PLAN**  
1/4" = 1' 0"

2308 SQ. FT. FINISHED  
990 SQ. FT. UNFINISHED

**RAW architecture**  
2990 Larimer Street  
Denver, Colorado 80205  
P: 303.651.4327  
F: 303.651.4328  
www.raw-architecture.com

A custom home design  
**JAMES RESIDENCE**  
LOT 47 WOODEN CANYON AT WATER DANCE  
Frisco, Colorado  
PROJECT # 0910



10-097

DATE	ISSUED FOR
03 19 10	CONCEPT
05 18 10	DESIGN DEVELOPMENT
07 23 10	DBS SUBMITTAL
08 02 10	SKETCH PLAN/FINAL PLAN SUBMITTAL
08 16 10	FOR CONSTRUCTION

SHEET

**A2.1**