

TUBULAR SKYLIGHT

Installation Guide



We thank you for purchasing an
ELITE TUBULAR SKYLIGHT

This product has a **LIFETIME-LIMITED WARRANTY** on all components against manufacturer defects, corrosion, rust, deteriorations, fading and breakage.

IMPORTANT:

PLEASE READ THE ENTIRE INSTALLATION GUIDE PRIOR TO COMMENCING.

TAKE SAFETY PRECAUTIONS WHEN WALKING ON THE ROOF.

DO NOT REMOVE LIGHT TUBE FILM UNTIL INSTRUCTED.

Tools Needed:

- Claw Hammer
- Pry Bar
- Plumb Tool
- Jigsaw
- Drill & Bits
- Screwdrivers
- Caulking Gun
- Drywall Saw
- Tin Snips

<u>Item</u>	<u>Description</u>
1	Dome Assembly
2	No. 8 x 3/8" Stainless Steel Screws
3	Dust Seal
4	Flashing (Seamless Aluminum)
5	No. 8 x 2" Stainless Steel Screws
6	Light Tubes (2-24" Tubes)
7	Foil Tape
8	No. 8 x 1/2" Self-drill Sheet Metal Screws
9	Flat Metal Nuts
10	Aluminum Trim Ring
11	No. 8 x 1 1/2" Sheet Metal Screws
12	Double Glaze Light Diffuser
13	Ceiling Decorative Ring

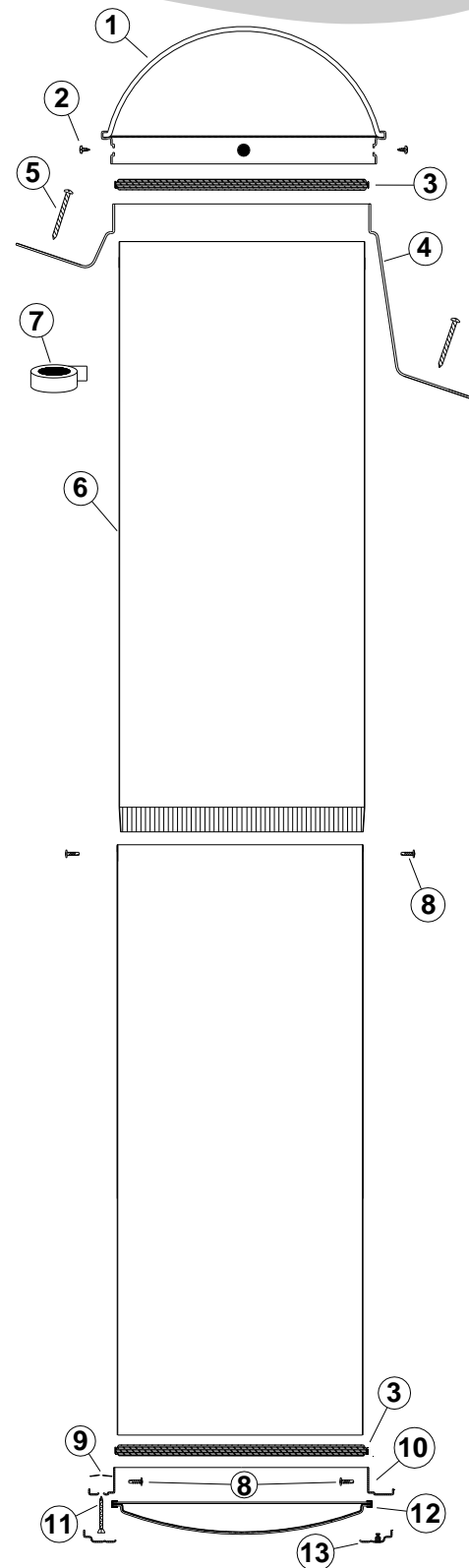

STEP 1: Locate desired placement for your new Elite Tubular Skylight. Punch a hole with a wire (or coat hanger) through ceiling. Inside attic, locate wire. Displace insulation and drill a hole centered between two frame members. Drop a plumb line or a similar object to mark and drill a hole through roof (**FIGURE 1**).

STEP 2: On top of roof, locate pre-drilled hole. Using supplied roof template, mark circumference of hole (**FIGURE 2**) for Flashing (**Item #4**). Cut hole with reciprocating saw.

SEE PAGE 4 FOR INSTRUCTIONS ON FLAT OR TILE ROOF INSTALLATIONS

FIGURE 1

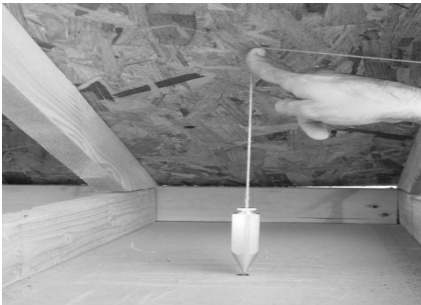

FIGURE 2

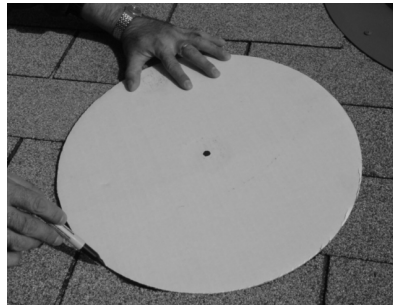

FIGURE 3



STEP 3: After cutting roof hole, cut two slits about 4" long each through roof material. Pull out nails or staples from center of hole, enough to be able to slide Flashing up (**Item #4**) under Tar Paper. Apply bead of supplied Roof Caulking under Flashing. Slide Flashing under roof material and secure with No. 8 x 2" Stainless Steel Screws (**Item #5, FIGURE 3**). Apply Dust Seal (**Item #3**) to inside top part of Flashing.

FIGURE 4



FIGURE 5



STEP 4: Back inside house, use supplied ceiling template to mark circumference of hole for Trim Ring (**Item #10**). Cut hole using a Drywall Saw. Fasten Trim Ring to ceiling with supplied Metal Flat Nuts (**Item #9**) and No.8 x 1 1/2" Sheet Metal Screws (**Item #11**). **DO NOT OVER TIGHTEN (FIGURE 4)**. Apply Dust Seal (**Item #3**) inside flange of Trim Ring. Dust Seal will help keep dust and bugs out of skylight.

STEP 5: Determine length of Light Tube needed (**Item #6**). Place each Light Tube together and pull protective film off of Light Tube about 2 inches away from edge where adhesive will make contact. Remove adhesive backing and overlap at offset. Press together and fasten with a No. 8 x 1/2" Self-Drill Sheet Metal Screw (**Item #8**) at center of each Light Tube. Pull protective film down about 2 inches and insert one Light Tube on top of other (as many as needed). Secure with 3 or more No. 8 by 1/2" Self-Drill Sheet Metal Screws (**Item #8, FIGURE 5**). Use Aluminum Foil Tape (**Item #7**) along and around Light Tube joints to seal completely.

STEP 6: Once Light Tubes are put together, these can be installed from the roof (**FIGURE 6**). Crimped side should go in first for easier install. Elbows can be used for obstructed attics.

STEP 7: Bring Light Tube down flush to Trim Ring. **DO NOT GO LOWER**; can be 1/4" higher from Trim Ring. Fasten Light Tube to Trim Ring with 3 or more No. 8 x 1/2" Self-Drill Sheet Metal Screws (**Item #8**). **DO NOT OVER TIGHTEN (FIGURE 7)**. Keep Light Tube as round as possible against Dust Seal.

FIGURE 6



FIGURE 7



FIGURE 8



STEP 8: On roof, trim Light Tube (if necessary) flush with top of Flashing using Tin Snips (**FIGURE 8**), or score outside of Light Tube with a utility knife at top level of Flashing and push against it to cut.

FIGURE 9



FIGURE 10



STEP 9: Remove protective film from Light Tube and install Dome Assembly (**Item # 1**). Secure to Flashing with No. 8 x 3/8" Stainless Steel Screws (**Item # 2, FIGURE 9**). **IMPORTANT: DO NOT APPLY ANY SILICONE AROUND DOME ASSEMBLY FOR IT CAN CREATE AND KEEP CONDENSATION INSIDE SKYLIGHT.** Finish roof installation by sealing around Flashing and gluing any loose shingles with supplied Roof Caulking. If desired, paint flashing to match roof color.

STEP 10: Finally, remove any protective film from inside Light Tube and install Ceiling Deco-Ring (**Item # 13**) with Light Diffuser (**Item # 12**). Install by aligning stand offs with keyholes and twist right (clock wise) until ring stops (**FIGURE 10**). **If Ceiling-Deco Ring ever needs to be removed for cleaning, twist left (counter clock wise), remove, clean and install back to original position.**

NOW ENJOY THE GREATEST LIGHTING SOURCE, WITH THE ELITE TUBULAR SKYLIGHT

****REMINDER: FOR OPTIMAL RESULTS, DO NOT FORGET TO REMOVE PROTECTIVE FILM FROM INSIDE LIGHT TUBES. MAKE SURE TO SEAL AND GLUE LOOSE SHINGLES ALL AROUND FLASHING WITH SUPPLIED HIGH QUALITY ROOF CAULKING****

INSTRUCTIONS FOR FLAT ROOF INSTALLATIONS

STEP 1: Locate desired placement for your new Elite Tubular Skylight. If building does not have an attic and if ceiling joists cannot be seen, use a stud finder or tap lightly to find approximate center point between two joists. Drill hole through ceiling and roof walls using a long drill.

STEP 2: On roof, locate pre-drilled hole. Use supplied roof template to mark circumference of hole for Flashing. Cut hole (**DO NOT CUT ANY FRAME MEMBERS**). Apply two ½" thick beads of High Quality Roof Caulking (*supplied*) on under side of Flashing. Secure to roof using No. 8 x 2" or longer Stainless Steel Screws (**Item # 5, FIGURE 11**).

FIGURE 11



FIGURE 12



STEP 3: Apply a 4" wide reinforcement fabric around perimeter of Flashing and high quality roofing mastic (*not supplied*) to double seal any potential water leakage (**FIGURE 12**). To complete installation, follow **STEPS 4** through **10**, same as Shingle Roof instructions.

INSTRUCTIONS FOR TILE ROOF INSTALLATIONS

STEP 1: Follow **STEP 1** as for Shingle Roof installation.

STEP 2: On top of roof, remove several tiles around pre-drilled hole. Use roof template to mark circumference of hole for Flashing and cut hole (**FIGURE 13**). Cut two 4" slits at center or lower sides of hole to slide Flashing under Black Tar Paper and apply two ½" beads of High Quality Roof Caulking (*supplied*) on under side of Flashing. Place Flashing centered with hole and secure to roof using No. 8 x 2" Stainless Steel Screws (**Item # 5**).

STEP 3: Replace tiles at lower side of Flashing. Place Aluminum Skirt with EPDM Rubber (*supplied for Tile Roofs*) over Flashing as shown (**FIGURE 14**). Adjust Aluminum Skirt to fit profile of tiles. Cut rest of tiles to fit around Flashing as needed and apply roof caulking wherever may be needed.

FIGURE 13



FIGURE 14



FIGURE 15



STEP 4: Apply Roof Caulking at any gaps created between aluminum and EPDM Rubber while contouring Aluminum Skirt to tiles (**FIGURE 15**). Paint to match color of roof. To complete installation, follow **STEPS 4** through **10**, same as Shingle Roof instructions.

OUR PRODUCT HAS A LIFETIME LIMITED WARRANTY

IF ANY QUESTIONS OR PROBLEMS SHALL ARISE, PLEASE FEEL FREE TO CONTACT US AT ELITESOLARSYSTEMS.COM OR CALL 866-772-5418

AGAIN, WE THANK YOU FOR CHOOSING

ELITE SOLAR SYSTEMS

FOR YOUR SOLAR LIGHTING NEEDS



Made in U.S.A